

0,491ha

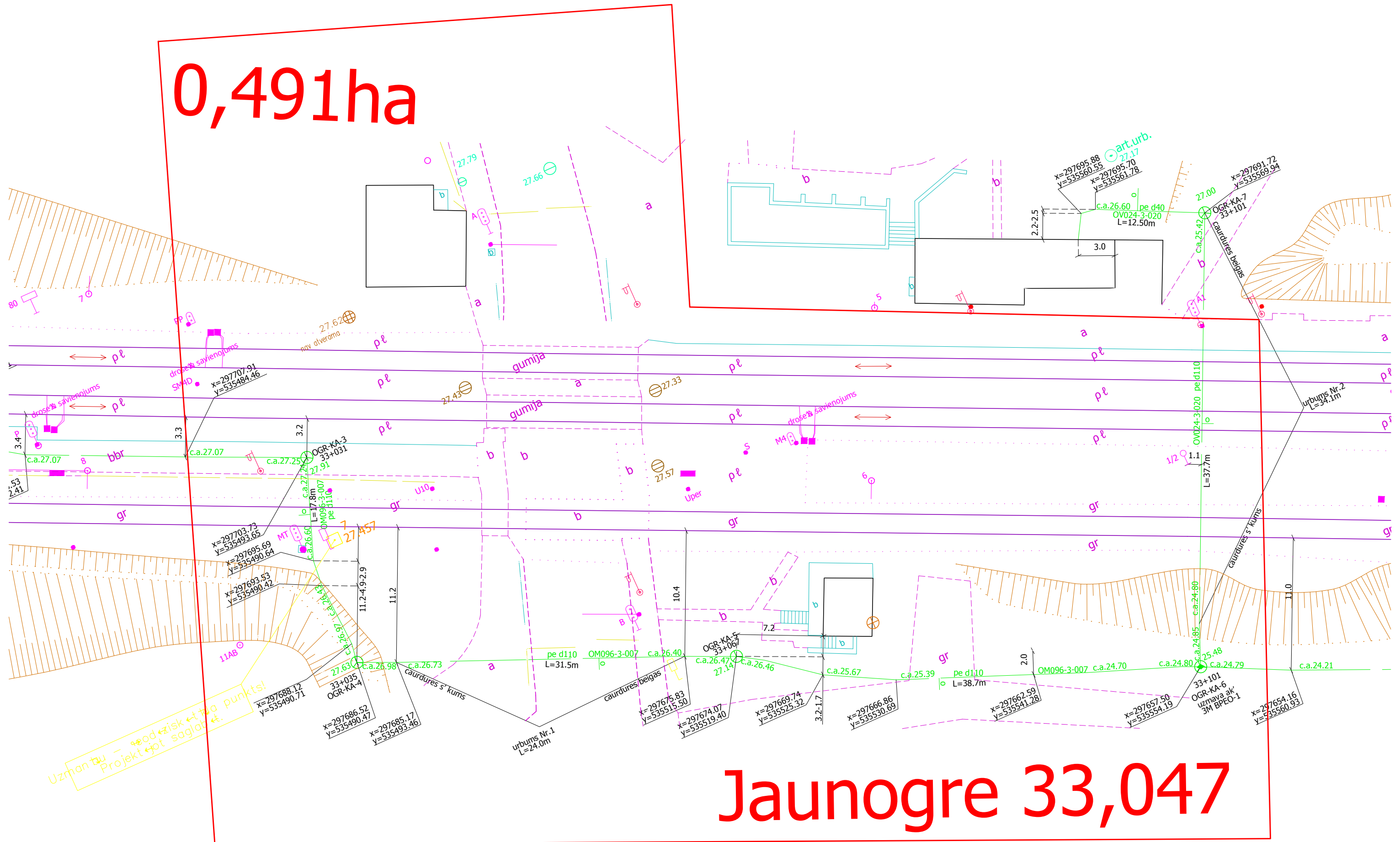

Jaunogre 33,047

St. Bene
87,268km

1.8 ha

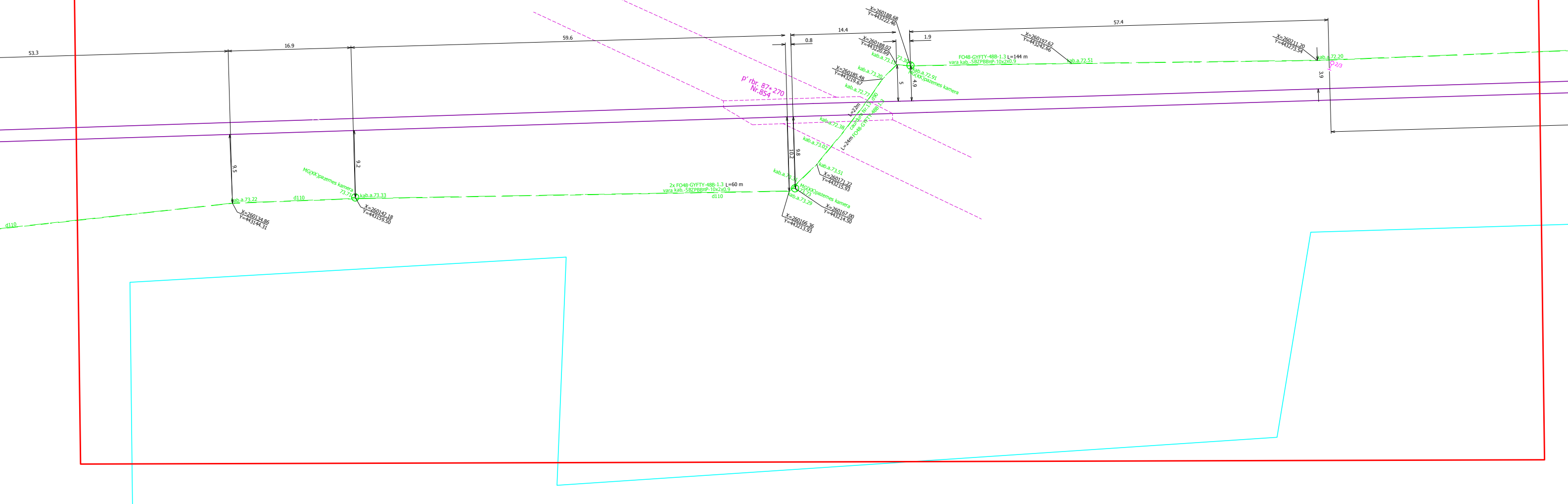

St. Carnikava 30,241km

0,502ha

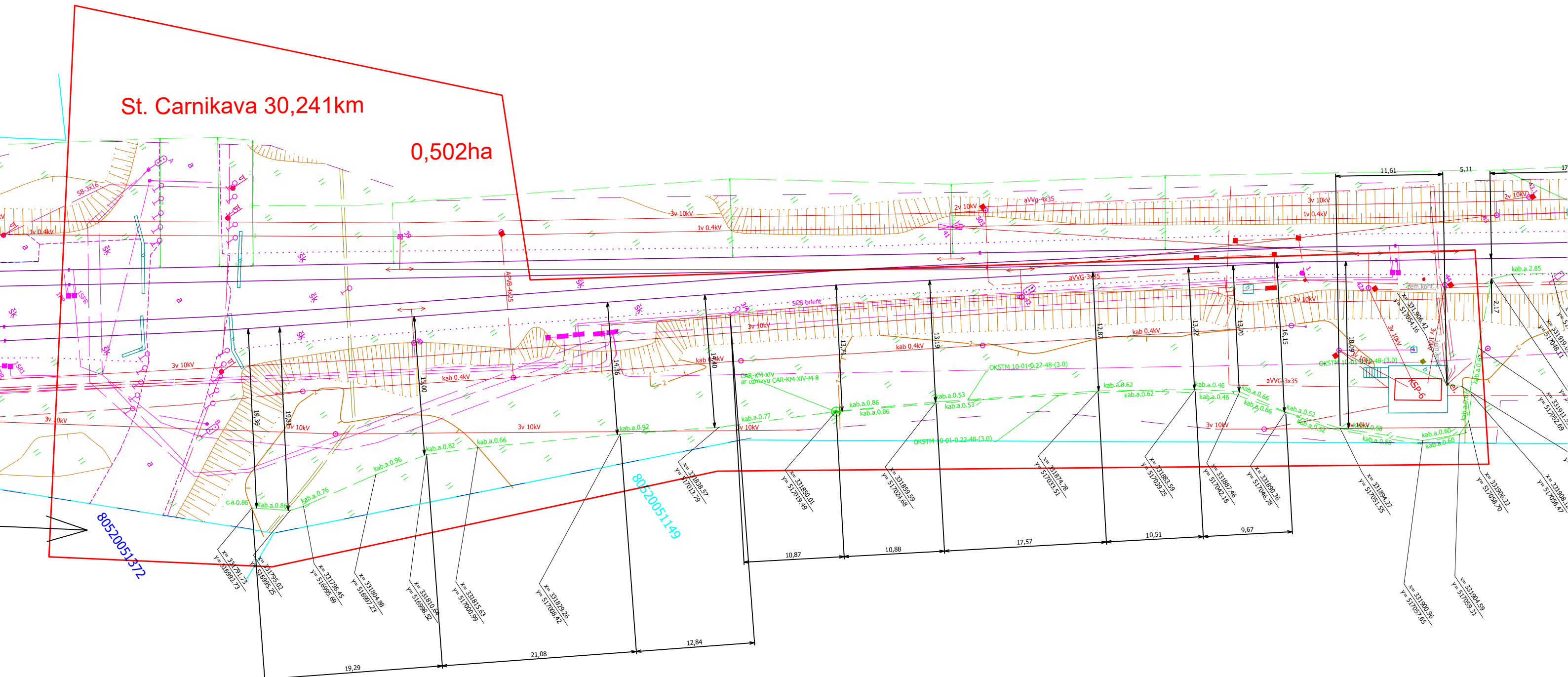

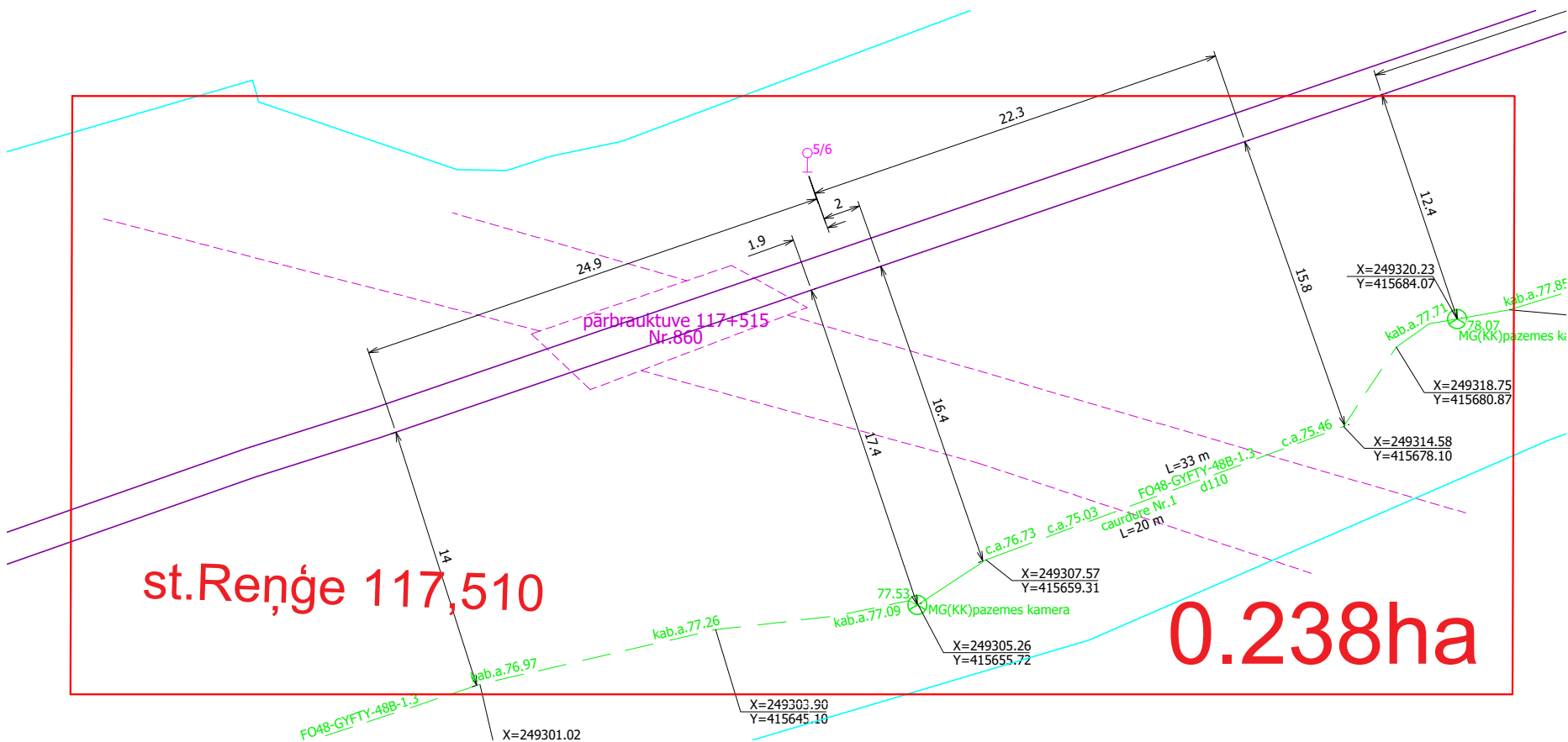

st. Reņģe 117,510

0.238ha

pārbrauktuve 117+515
Nr.860

FO48-GYFTY-488-1.3
caurdure Nr.1
d110
L=20 m

FO48-GYFTY-488-1.3
L=33 m

MG(KK) pazemes kamera

MG(KK) pazemes ka

FO48-GYFTY-488-1.3

X=249301.02

X=249303.90
Y=415645.10

X=249307.57
Y=415659.31

X=249305.26
Y=415655.72

X=249320.23
Y=415684.07

X=249318.75
Y=415680.87

X=249314.58
Y=415678.10

ilaste

st.Saukrasti 48,252km

0,606ha

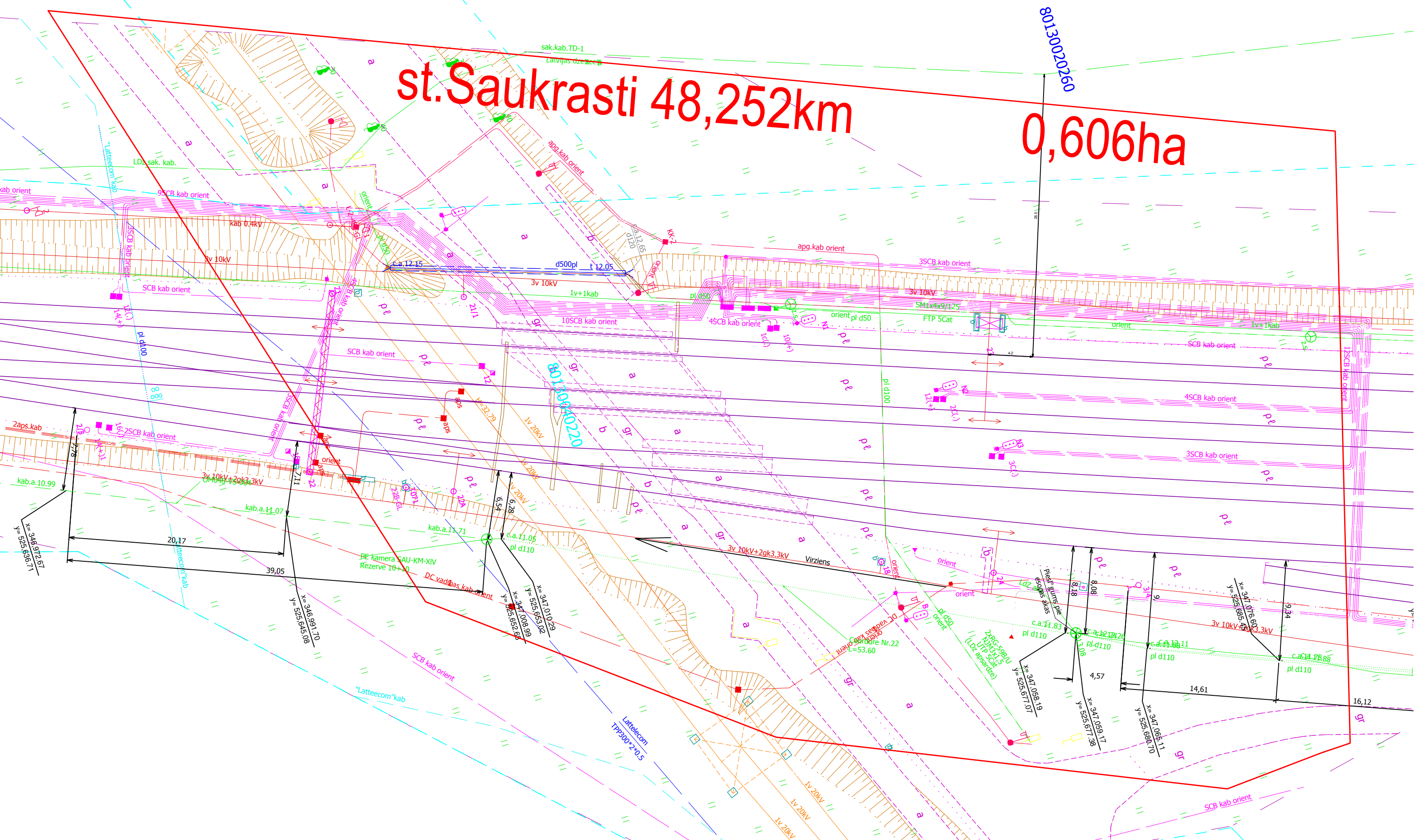

sak.kab.TD-1
Latvijas dzelzceļš

LDZ sak. kab.

2aps.kab

kab.a.10.99

kab.a.11.07

20,17

39,05

x=346,912,61
y=525,936,71

x=346,991,710
y=525,945,308

x=347,000,982
y=525,952,632

x=347,000,982
y=525,952,632

x=347,000,982
y=525,952,632

x=347,000,982
y=525,952,632

x=347,000,982
y=525,952,632

x=347,000,982
y=525,952,632

PE kamera SAU-KM-XIV
Rezerve 10+10

DC vadības kab orient

"Lattecom" kab

Lattecom
TPP30P*2*0,5

Virziens

ca.11.83
ca.11.83
ca.11.83

ca.11.83
ca.11.83
ca.11.83

ca.11.83
ca.11.83
ca.11.83

ca.11.83
ca.11.83
ca.11.83

ca.11.83
ca.11.83
ca.11.83

80130040220

80130020260

12SCB kab orient

gr

gr

gr

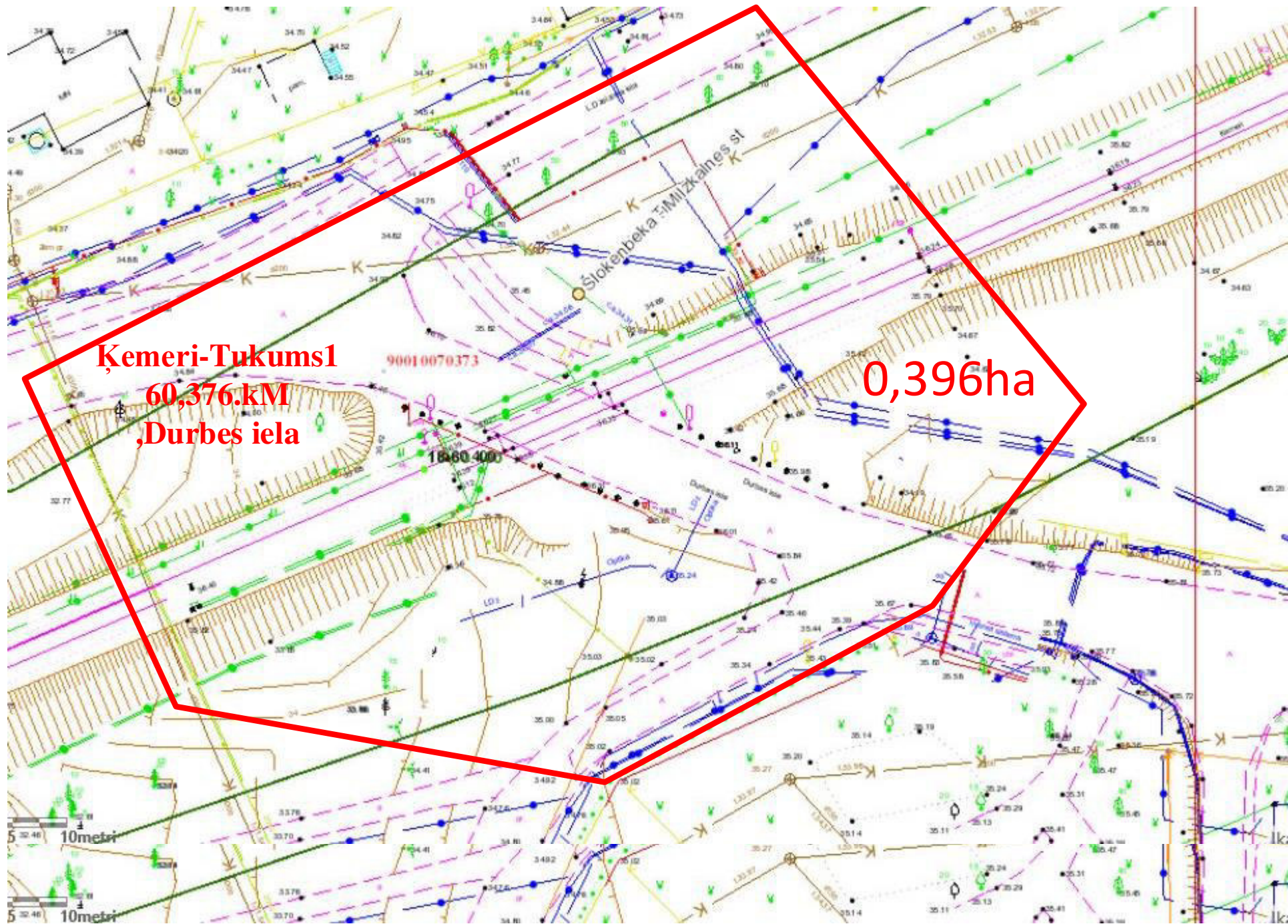

Kēmeri-Tukums1

60,376.kM

,Durbes iela

0,396ha

90010070373

1880400

5 10metri

5 10metri

Stokenbeka-Mizkaines st

Durbes iela